



Rhif y Cais / Application Number : C16/1108/23/LL

Cynllun lleoliad ar gyfer adnabod y safle yn unig. Dim i raddfa.  
Location Plan for identification purposes only. Not to scale.



Atgynhyrhir y map hwn o Ddaunydd yr Ordnance Survey gyda ohanlathd yr Ordnance Survey ar ran Rheolwr Llyfrfa El Mawrthdi.  
© Hawlfraint y Goron.  
Mae atgynhyrchu heb ganiatâd yn torri hawlfraint y Goron a gall hyn anwain at erlyniad neu achos sifil.  
Cynllun Gwynedd - 10023387 - 2008

This map is reproduced from Ordnance Survey material with the permission of Ordnance Survey on behalf of the Controller of Her Majesty's Stationery Office  
© Crown copyright  
Unauthorised reproduction infringes Crown copyright and may lead to prosecution or civil proceedings.  
Cynllun Gwynedd - 10023387 - 2008

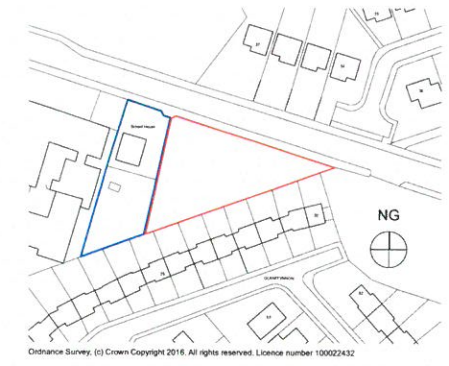
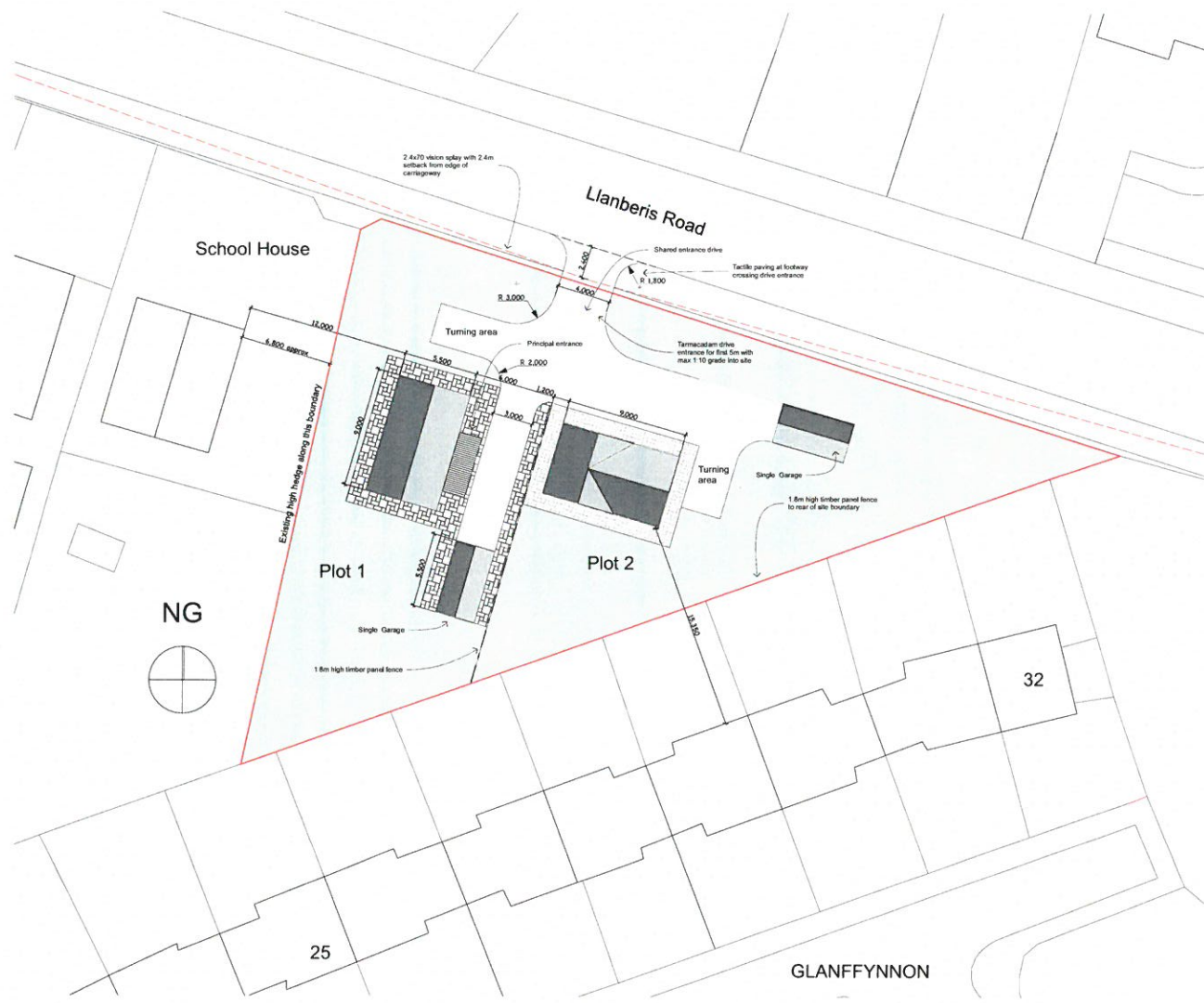

Distance Survey. (c) Crown Copyright 2016. All rights reserved. Licence number 100022432

B	Site to left edged in blue	07/09/2016
A	House on plot 2 adjusted in line with planning officers comments	13/07/2016
Revision	Description	Issued Date



Pier House    St Georges Road    Menai Bridge    Anglesey LL59 5EY  
 t: 01248 717230    e: office@erwdesign.co.uk    w: www.erwdesign.co.uk

**Proposed Site Layout**  
**Land adjacent Ty'r Ysgol**  
**Llanrug**

**Proposed site layout**

ERW Surveyors		drawing status	
project	SH1543	number	rev
originator	scale @ A2	number	rev
NM	1:1250, 1:250	A.00.1	B

This document and its design content is copyright and is protected by the Copyright, Designs and Patents Act 1988. It shall be read in conjunction with all other associated project information including models, specifications, schedules and related consultancy documents. Do not scan from documents. All dimensions to be checked on site. Immediately report any discrepancies, errors or omissions on the document to the Originator. If in doubt ASK.