

Rhif y Cais / Application Number : C15-0872-44-LL

Cynllun lleoliad ar gyfer adnabod y safle yn unig. Dim i raddfa.
Location Plan for identification purposes only. Not to scale.



Atgynhyrchir y map hwn o Ddeunydd yr Ordnance Survey gyda oherstrawd yr Ordnance Survey ar ran Rheolwr Llyfrfa E. Mawrthdy.
© Hawlfraint y Goron.
Mae atgynhyrchu heb ganiatâd yn torri hawlfraint y Goron a gall hyn arwain at ethylriad neu achos sifil.
Dyngor Gwynedd - 100023357 - 2008

This map is reproduced from Ordnance Survey material with the permission of Ordnance Survey on behalf of the Controller of Her Majesty's Stationery Office
© Crown copyright
Unauthorised reproduction infringes Crown copyright and may lead to prosecution or civil proceedings.
Dyngor Gwynedd - 100023357 - 2008



NOTES: THIS DRAWING IS THE COPYRIGHT OF BRATHERTON PARK DESIGN LTD.

1. THIS DRAWING IS NOT TO BE SCALED
 2. ALL DIMENSIONS TO BE CHECKED ON SITE BY THE CONTRACTOR
- ANY AMBIGUITIES AND/OR OMISSIONS BETWEEN THIS DRAWING AND INFORMATION GIVEN ELSEWHERE MUST BE REPORTED IMMEDIATELY TO THE ENGINEER FOR CLARIFICATION BEFORE PROCEEDING. THE CONTRACTOR MUST CHECK THE LOCATION OF EXISTING SERVICES AND ASCERTAIN THE EXISTENCE OF ANY PREVIOUSLY UNKNOWN SERVICES ON THE SITE BEFORE BEGINNING ANY EXCAVATIONS.

KEY

— OWNERSHIP BOUNDARY

— APPLICATION BOUNDARY

REV	DESCRIPTION	DATE	INITIALS

Bratherton 

PARK DESIGN CONSULTANTS

Mollington Grange • Parkgate Road • Mollington
Chester • CH1 6HP

T. 01244 853 000 • F. 01244 853 807
E. parkdesign@bratherton.co.uk W. www.bratherton.co.uk

GREENACRES HOLIDAY PARK - SAFARI TENTS

LOCATION PLAN

DATE: 03/08/15	SCALE: 1:2500	© A2
DRAWN: LD	CHECKED: REV:	JOB: 781/33/13

NOTES: THIS DRAWING IS THE COPYRIGHT OF BRATHERTON PARK DESIGN LTD.

1. THIS DRAWING IS NOT TO BE SCALED
2. ALL DIMENSIONS TO BE CHECKED ON SITE BY THE CONTRACTOR ANY AMBIGUITIES AND/OR OMISSIONS BETWEEN THIS DRAWING AND INFORMATION GIVEN ELSEWHERE MUST BE REPORTED IMMEDIATELY TO THE ENGINEER FOR CLARIFICATION BEFORE PROCEEDING. THE CONTRACTOR MUST CHECK THE LOCATION OF EXISTING SERVICES AND ASCERTAIN THE EXISTENCE OF ANY PREVIOUSLY UNKNOWN SERVICES ON THE SITE BEFORE BEGINNING ANY EXCAVATIONS.
3. BASES ARE TO BE A MINIMUM OF 6m APART FROM SIDE TO SIDE. SEE CRITICAL DIMENSIONS DWG.
4. EACH BASE IS TO BE A MINIMUM OF 3m AWAY FROM ROADSIDE.
5. EACH BASE IS TO BE PROVIDED WITH GRAVEL AWNING SPACE. SEE TYPICAL DETAILS DRAWING No. 781/37/11.
6. ACCESS ROADS ARE TYPICALLY 4m OR 5m WIDE. SEE CRITICAL DIMENSIONS DWG.

HIGH LEVEL AURIGA LAMP COLUMN



LIGHTING KEY

(NB: ALL LIGHTING INSTALLED BY ELECTRICAL CONTRACTOR)

- 5m HIGH LAMP COLUMN WITH AURIGA HEAD (9 No.)
- LOW LEVEL TIMBER 3 WAY BOLLARD LIGHT (2 No. AT ENTRANCE)
- UPLIGHTER FOR FEATURE WALLS (4 No.)

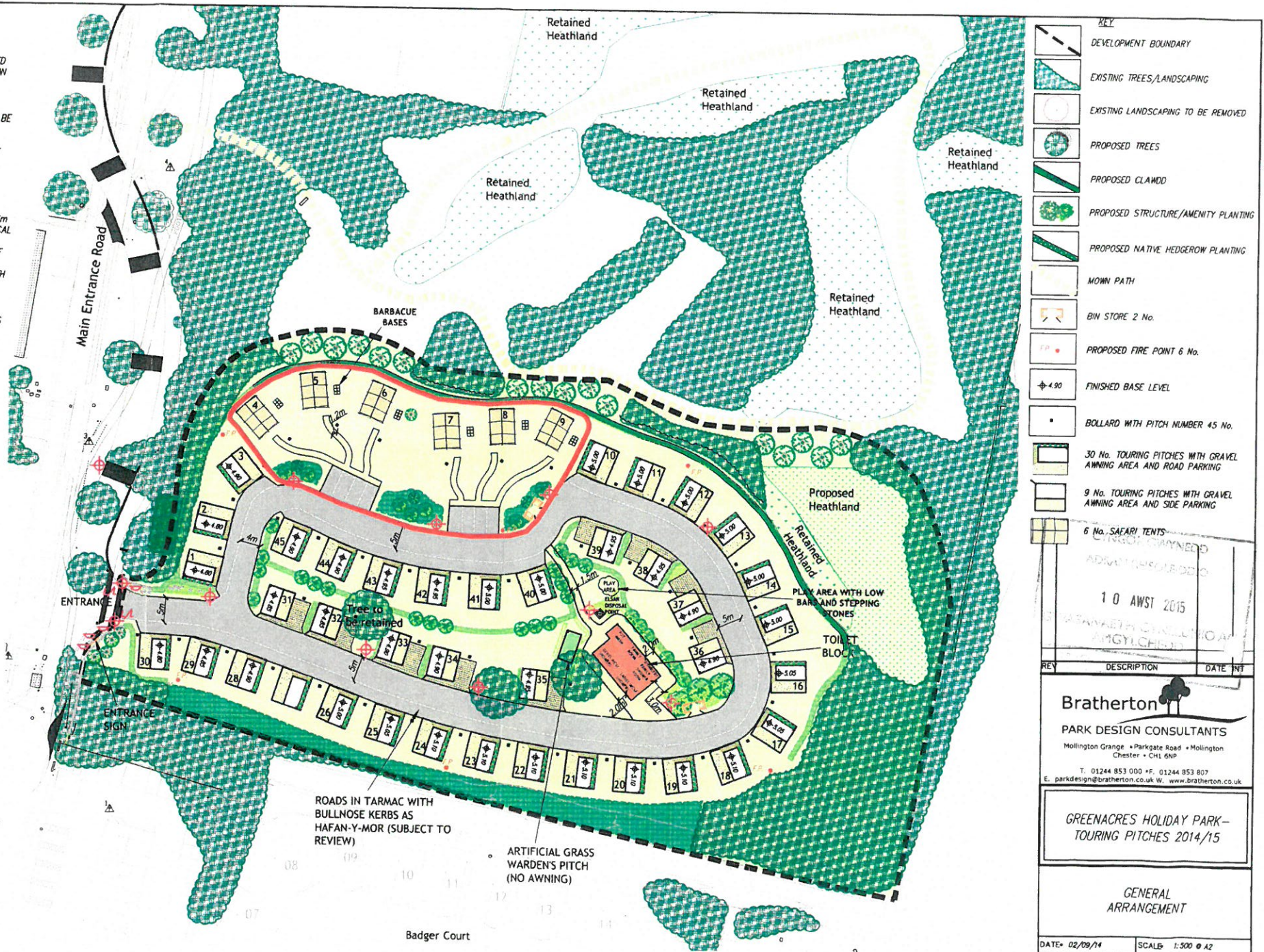

KEY

- DEVELOPMENT BOUNDARY
- EXISTING TREES/LANDSCAPING
- EXISTING LANDSCAPING TO BE REMOVED
- PROPOSED TREES
- PROPOSED CLAWDD
- PROPOSED STRUCTURE/AMENITY PLANTING
- PROPOSED NATIVE HEDGEROW PLANTING
- MOWN PATH
- BIN STORE 2 No.
- PROPOSED FIRE POINT 6 No.
- FINISHED BASE LEVEL
- BOLLARD WITH PITCH NUMBER 4.5 No.
- 30 No. TOURING PITCHES WITH GRAVEL AWNING AREA AND ROAD PARKING
- 9 No. TOURING PITCHES WITH GRAVEL AWNING AREA AND SIDE PARKING
- 6 No. SAFARI TENTS

10 AWST 2015

REV	DESCRIPTION	DATE	INT

Bratherton
PARK DESIGN CONSULTANTS
Mollington Grange • Parkgate Road • Mollington
Chester • CH1 6NP
T. 01244 853 000 • F. 01244 853 807
E. parkdesign@bratherton.co.uk • www.bratherton.co.uk

GREENACRES HOLIDAY PARK – TOURING PITCHES 2014/15

GENERAL ARRANGEMENT

DATE= 02/09/14	SCALE= 1:500 @ A2
DRAWN= LD	CHECKED=
REV=	JOB= 781/37/12

FLOOR SHEETS TO BE OSB3 2400MM X 1220MM X 18mm OR EQUIVALENT

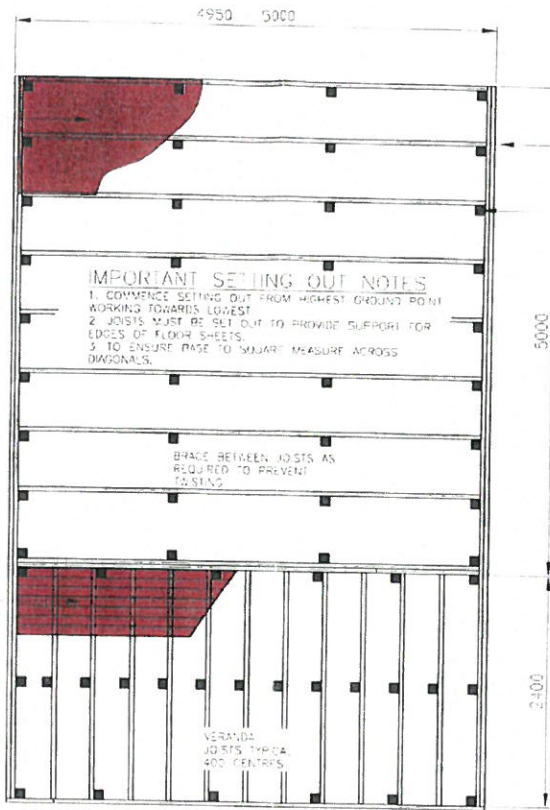

IMPORTANT SETTING OUT NOTES
 1. COMMENCE SETTING OUT FROM HIGHEST GROUND POINT WORKING TOWARDS LOWEST
 2. JOISTS MUST BE SET OUT TO PROVIDE SUPPORT FOR EDGES OF FLOOR SHEETS.
 3. TO ENSURE BASE TO SQUARE MEASURE ACROSS DIAGONALS.

BRACE BETWEEN JOISTS AS REQUIRED TO PREVENT TWISTING

VERANDA COVERED WITH KILN DRIED SAWN TREATED TIMBER 100MM X 19MM OR EQUIVALENT

BASE PLAN SCALE 1:25

JOIST FRAME TO BE C16 GRADE KILN DRIED SAWN TREATED TIMBER 100X47mm OR EQUIVALENT

100mm x 100mm POSTS LEVELLED TO SUIT GROUND CONDITIONS

VERANDA SET OUT LOWER THAN TENT BASE TO PROVIDE A STEP AND ALLOW INNER TENT FLOOR SHEET TO FINISH FLUSH. RECOMMEND 100mm THICK EDGE TIMBERS REQUIRED AT CORNERS WITH AN BASE TO PROVIDE TRIM FOR TENT FRAME LEGS

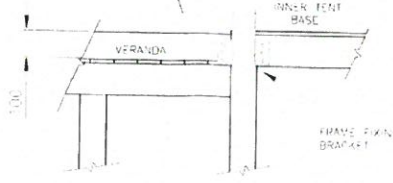

ELEVATION VIEW AA NTS

MATERIALS LIST		
No	ITEM	QUANTITY
1	RECOMMEND ALL JOISTS TO BE C16 GRADE KILN DRIED SAWN TREATED TIMBER 100X47mm OR EQUIVALENT	APPROX 120M
2	RECOMMEND FLOOR SHEETS TO BE OSB3 2400MM X 1220MM X 18mm OR EQUIVALENT	APPROX 9 SHEETS / 25M ²
3	RECOMMEND VERANDA COVERED WITH KILN DRIED SAWN TREATED TIMBER 100MM X 19mm OR EQUIVALENT	APPROX 120M / 12M ²
4	RECOMMEND GROUND POSTS 100mm x 100mm LENGTHS TO SUIT GROUND CONDITIONS	APPROX 60 POSTS LENGTH TO SUIT GROUND CONDITIONS
5	SCREWS EXTERNAL GRADE RECOMMEND NO10 3" FOR ALL JOIST FIXINGS AND 10# 2" FOR SHEETS AND VERANDA BOARD FIXING TENT LEGS TO BE FIXED WITH M10 X 75MM COARSE THREAD COACH BOLTS	QUANTITY TO SUIT

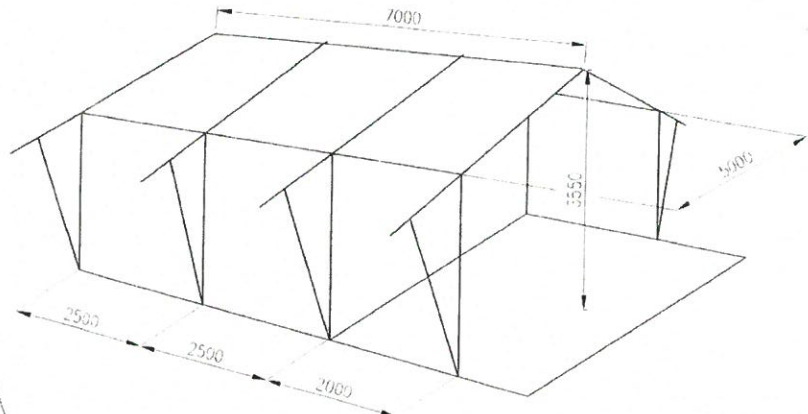

ISOMETRIC VIEW NTS



NTS
 1. DIMENSIONS ARE NOT TO BE SCALED FROM THIS DRAWING. ANY DIMENSIONS ADDITIONAL ARE TO BE CHECKED ON SITE

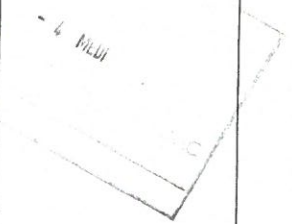

This drawing and information contained within is Copyright © Clear Sky Safari Tents

Client	STI
Drawn by	STI
Checked by	STI
Scale	1:25



Clear Sky Safari Tents
 188 191 194

CUSTOMER DETAILS			
Customer Name	STI	Address	
Phone		Fax	
Project No		Date	
Drawing No	STI WOODY	Drawing Date	