

Rhif y Cais / Application Number : C17/0437/22/LL

Cynllun lleoliad ar gyfer adnabod y safle yn unig. Dim i raddfa.
Location Plan for identification purposes only. Not to scale.

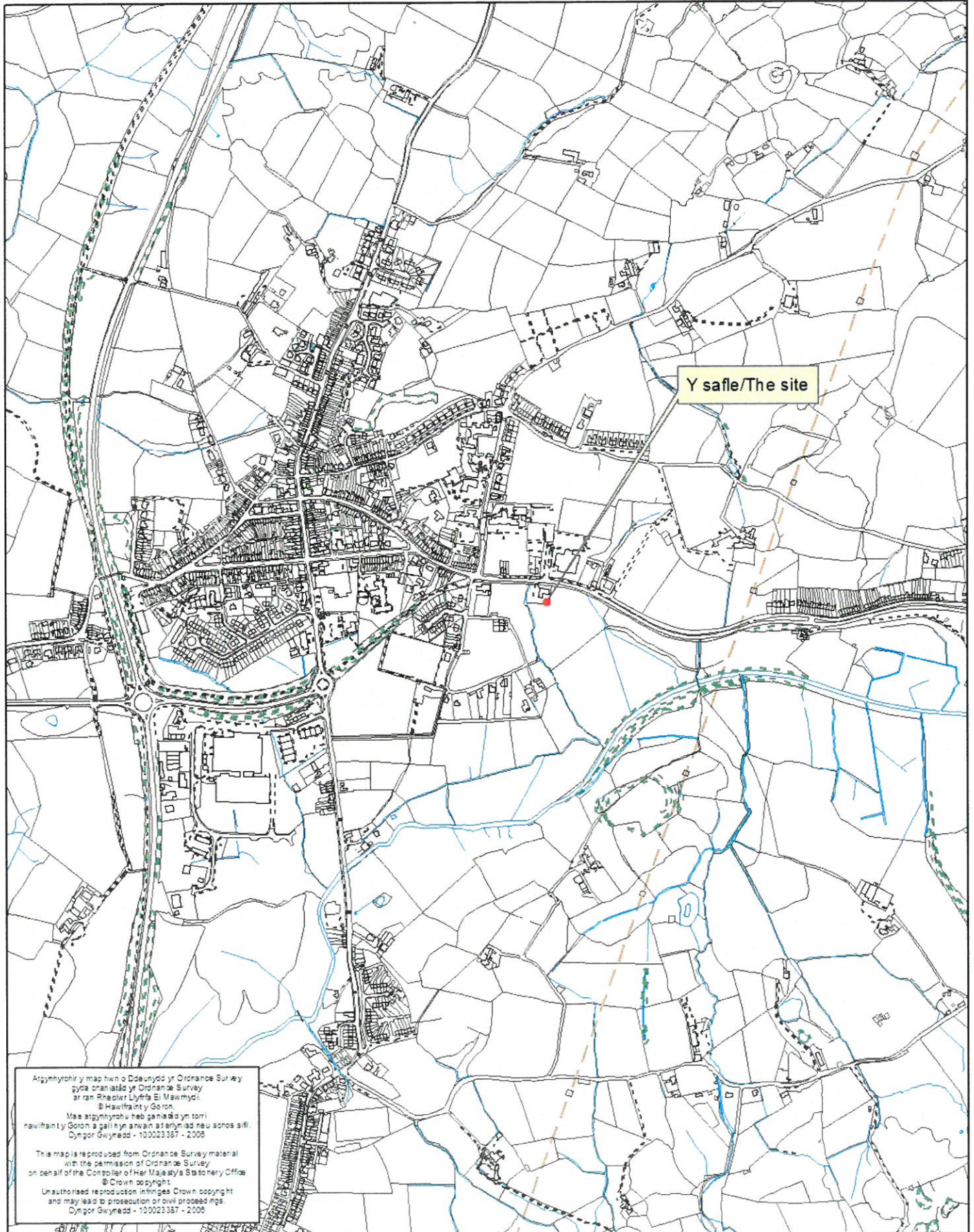

Y safle/The site

Atgynhyrchir y map hwn o Ddauydd yr Ordnance Survey
gyda oriantaio yr Ordnance Survey
ar rhan Rheolwr Llyfrfa Eri Maswmyd.
© Hawlfraint y Goron.
Mae atgynhyrchu heb ganiadau yn torri
hawlfraint y Goron a gall hyn arwain at enbydd neu achos sifil.
Cynllun Gwynedd - 100023357 - 2005

This map is reproduced from Ordnance Survey material
with the permission of Ordnance Survey
on behalf of the Controller of Her Majesty's Stationery Office
© Crown copyright
Unauthorised reproduction infringes Crown copyright
and may lead to prosecution or civil proceedings.
Cynllun Gwynedd - 100023357 - 2005

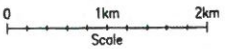
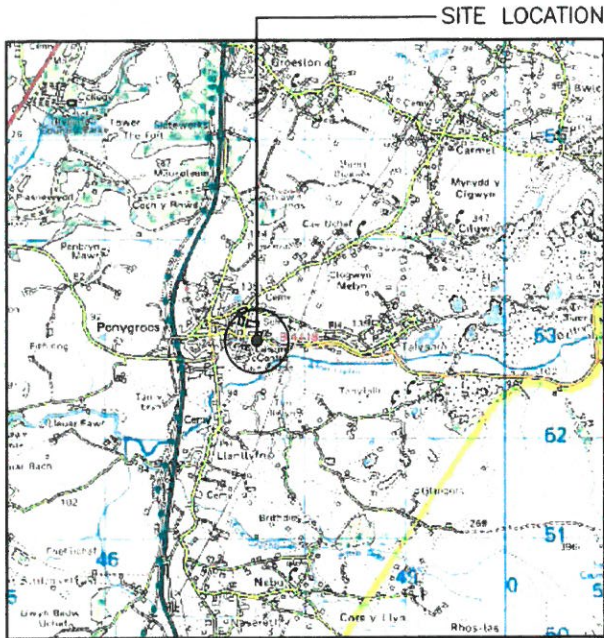

SITE LOCATION
(Scale 1:50000)

Ordnance Survey map extract based upon Landranger map series with the permission of the controller of Her Majesty's Stationery Office. Licence No. 0100023487. Crown copyright.



SITE PHOTOGRAPH

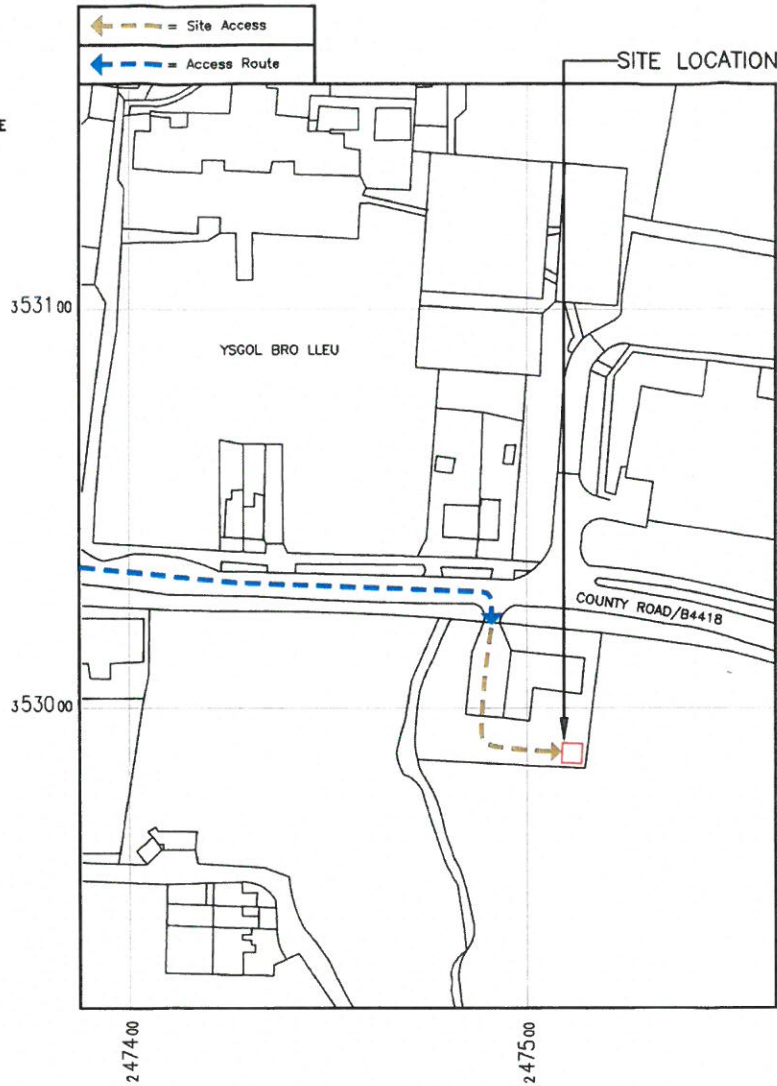

DETAILED SITE LOCATION
(Scale 1:1250)

Based upon Ordnance Survey map extract with the permission of the Controller of Her Majesty's Stationery Office. Crown copyright. Licence No. 100020449



ALL DIMENSIONS ARE IN mm UNLESS NOTED OTHERWISE

N.G.R | E: 247511 N: 35291

CONCESSION REQUIRED | NO

DIRECTIONS TO SITE:
FROM CAERNARFON, FOLLOW THE A487 TOWARDS PENYGROES. AT PENYGROES ROUNDABOUT, TAKE THE FIRST EXIT ONTO B4418. AT THE NEXT ROUNDABOUT, TAKE THE FIRST EXIT AND STAY ON B4418. TURN RIGHT ONTO VICTORIA ROAD/B4418. TURN RIGHT ONTO COUNTY ROAD/B4418. AFTER 0.2mi, TURN RIGHT INTO TELEPHONE EXCHANGE. THE SITE IS LOCATED ON THE RIGHT, DOWN THE GRASS EMBANKMENT.



NOTES:

D	Amended to site survey	BH	MT	17.03.17
C	Site location moved	RKB	MT	14.12.16
B	Site name & address amended	BH	MT	07.11.16
A	Issued for Approval	BH	MT	19.10.16

REV	MODIFICATION	BY	CH	DATE
-----	--------------	----	----	------

Cell Name		Opt.
PENYGROES ATE		-
Cell ID No		
CTIL	TEF	VF
208016	-	13284

Site Address / Contact Details

ERW FAIR
COUNTY ROAD
PENYGROES
CAERNARFON
LL54 6HE

Drawing Title		SITE LOCATION MAPS	
Purpose of issue:		PLANNING	Dwg Rev.
Drawing Number:		100	D
Surveyed By:	CP	Original Sheet Size	A3
Drawn:	BN	Date:	19.10.16
Checked:	MT	Date:	19.10.16
Issue:			F

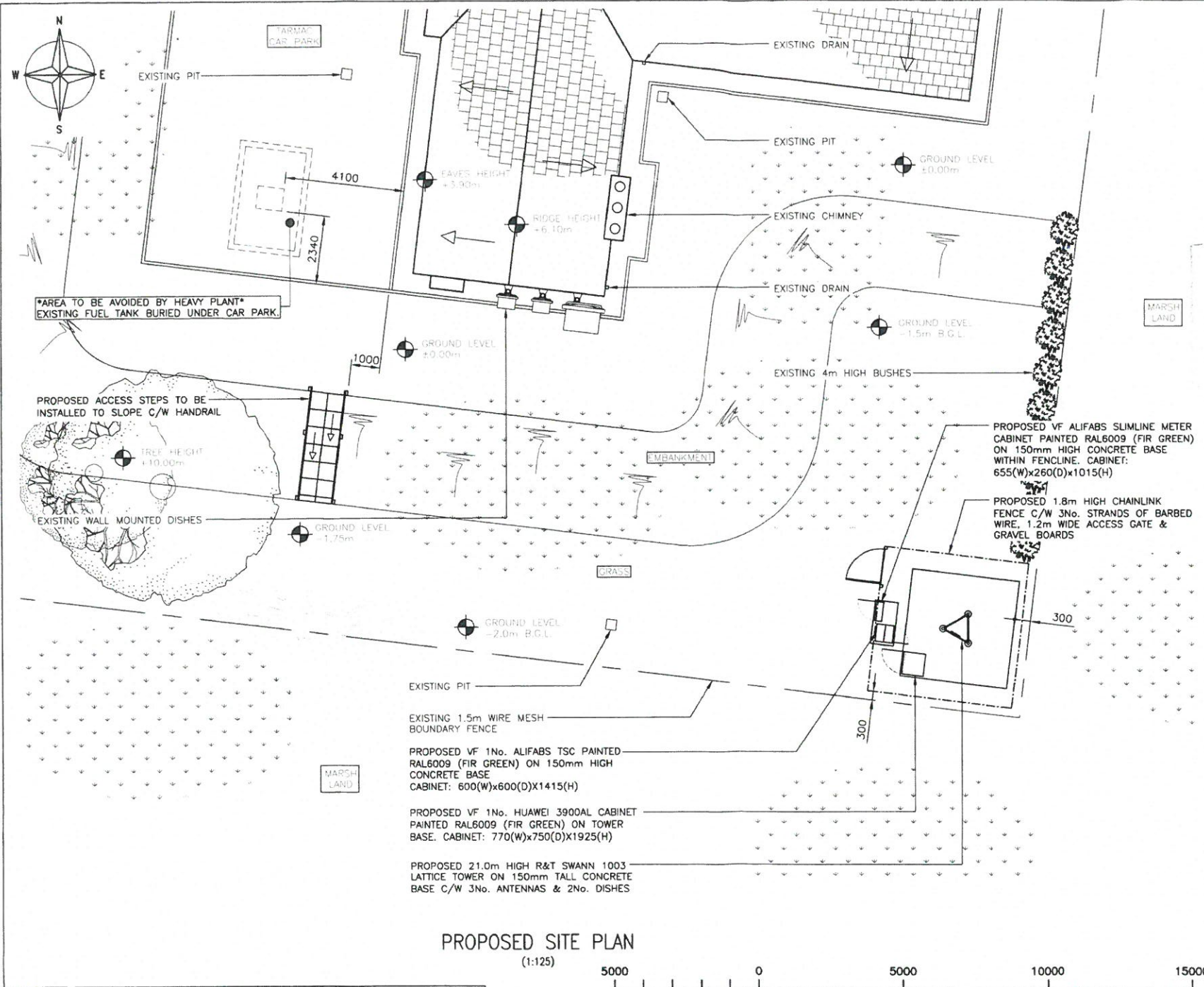

ALL DIMENSIONS ARE IN mm UNLESS NOTED OTHERWISE

N.G.R. E: 247511 N: 352991

CONCESSION REQUIRED NO

NOTES:
 1 R&T SWANN 21.0m HIGH 1003 LATTICE TOWER TO BE ORDERED & DELIVERED IN 3.0m SECTIONS TO AID WITH ACCESS & DELIVERY CONCERNS.

REV	MODIFICATION	BY	CH	DATE
C	Amended to site survey	BH	MT	17.03.17
D	Surrounding landscape amended	BH	MT	09.02.17
C	Site location moved	RGB	MT	14.12.16
B	Site name & address amended	BH	MT	07.11.16
A	Issued for Approval	BH	MT	19.10.16

KTL

27

KTU

Infra Projects

Sustainable | Innovative

vodafone

GROW THE GRID

Cell Name		Opt.
PENYGROES ATE		-
Cell ID No		
CTIL	TEF	VF
208016	-	13284
Site Address / Contact Details		
ERW FAIR COUNTY ROAD PENYGROES CAERNARFON LL54 6HE		
Drawing Title: PROPOSED SITE PLAN		
Purpose of issue: PLANNING		Dwg Rev.
Drawing Number: 201		E
Surveyed By: CP	Original Sheet Size: A3	Pack Issue:
Drawn: BH	Date: 19.10.16	Checked: MT
	Date: 19.10.16	F

The drawings comply with TEF & Vodafone Standard ICNIRP guidelines.
 Designed in accordance with CTIL document: SDN0008

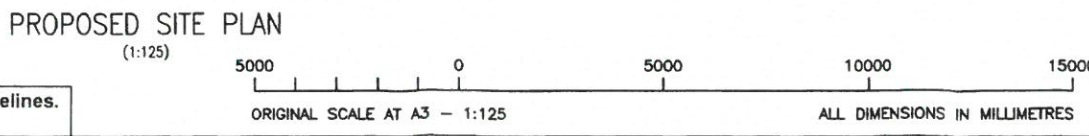

TOP OF PROPOSED STRUCTURE +21.00m AGL
 TOP OF PROPOSED ANTENNAS +21.00m AGL
 U/S OF PROPOSED ANTENNAS +19.00m AGL
 C/L OF PROPOSED DISH +17.50m AGL

PROPOSED 21.0m HIGH R&T SWANN 1003 LATTICE TOWER ON 150mm HIGH CONCRETE BASE C/W 3No. ANTENNAS & 2No. DISHES

TREE HEIGHTS +10.0m AGL

EXISTING WALL MOUNTED DISHES

ROOF RISE HEIGHT +6.10m AGL

LEAVES HEIGHT +3.50m AGL

GROUND LEVEL +0.00m

-1.10m B.G.L.

PROPOSED ACCESS STEPS TO BE INSTALLED TO SLOPE C/W HANDRAIL

PROPOSED VF ALIFABS SLIMLINE METER CABINET PAINTED RAL6009 (FIR GREEN) ON 150mm HIGH CONCRETE BASE WITHIN FENCELINE. CABINET: 655(W)x260(D)x1015(H)

PROPOSED VF 1No. ALIFABS TSC PAINTED RAL6009 (FIR GREEN) ON 150mm HIGH CONCRETE BASE. CABINET: 600(W)x600(D)x1415(H)

PROPOSED VF 1No. HUAWEI 3900AL CABINET PAINTED RAL6009 (FIR GREEN) ON TOWER BASE. CABINET: 770(W)x750(D)x1925(H)

PROPOSED 1.8m HIGH CHAINLINK FENCE C/W 3No. STRANDS OF BARBED WIRE. 1.2m WIDE ACCESS GATE & GRAVEL BOARDS. (PARTIALLY OMITTED FOR CLARITY)

EXISTING WIRE MESH BOUNDARY FENCE

AREA TO BE AVOIDED BY HEAVY PLANT
 EXISTING FUEL TANK BURIED UNDER CAR PARK.

PROPOSED NORTH WEST ELEVATION
 (1:100)



ALL DIMENSIONS ARE IN mm UNLESS NOTED OTHERWISE

N.G.R E: 247511 N: 352991

CONCESSION REQUIRED NO

NOTES:
 1 R&T SWANN 21.0m HIGH 1003 LATTICE TOWER TO BE ORDERED & DELIVERED IN 3.0m SECTIONS TO AID WITH ACCESS & DELIVERY CONCERNS.

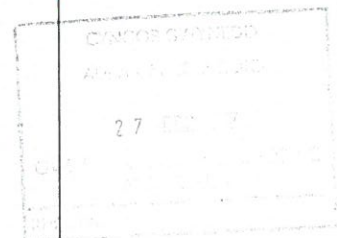

E	Amended to site survey	BH	MT	17.03.17
D	Surrounding landscape amended	BH	MT	09.02.17
C	Site location moved	RKB	MT	14.12.16
B	Site name & address amended	BH	MT	07.11.16
A	Issued for Approval	BH	MT	19.10.16
REV	MODIFICATION	BY	CH	DATE



Cell Name
 PENYGROES ATE

Cell ID No

CTIL	TEF	VF
208016	-	13284

Site Address / Contact Details

ERW FAIR COUNTY ROAD
 PENYGROES
 CAERNARFON
 LL54 6HE

Drawing Title
 PROPOSED SITE ELEVATION

Purpose of Issue:
PLANNING

Drawing Number:
 301

Surveyed By: CP	Original Sheet Size: A3	Pack Issue: E
Drawn: BH	Date: 19.10.16	Checked: MT
Date: 19.10.16	Date: 19.10.16	Date: 19.10.16